

DUNGARVAN / CAPPAGH AREA *Grawnfadda*

*c. 31 Hectares Roadside Lands with Wintering Facilities
for approximately 60 cattle.*

To Lease for 5 Years

- Prime quality land, currently all in permanent pasture.
- All in one unit, well fenced with mains fencing around perimeter.
- Suitable for tillage or grassland.
- Slatted wintering accommodation for approximately 60 cattle.
- Mains water supply
- Maps and Details available.

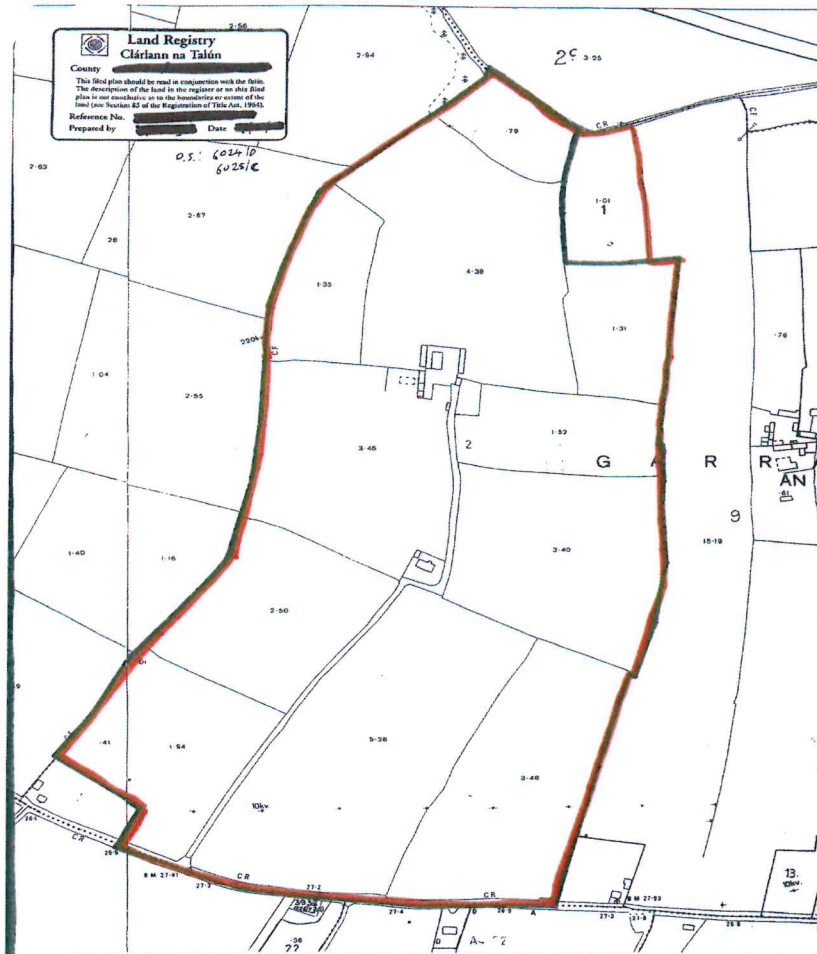

HARTY & CO.
*31 Hectares - To Lease for 5 Years
Grawnfadda, Dungarvan*

These particulars are issued by Harty & Co. on the understanding that any negotiations respecting the property mentioned are conducted through them. Every care is taken in preparing particulars but Harty & Co. do not hold themselves responsible for any inaccuracy in the terms and particulars of the properties referred to or for any expense that may be incurred in visiting the property should it be unsuitable or have been let, sold or withdrawn. Applicants are advised to make an appointment through us before viewing and are requested to report their opinion after inspecting. If the above is unsuitable please let us know your exact requirements. Any reasonable offer will be submitted to the owner for consideration. The contents of this brochure / form shall not be deemed to form the basis to any contract.